

MR BEAMS®

MB10026  
NOSTALGIC LED STRING LIGHTS, ST58

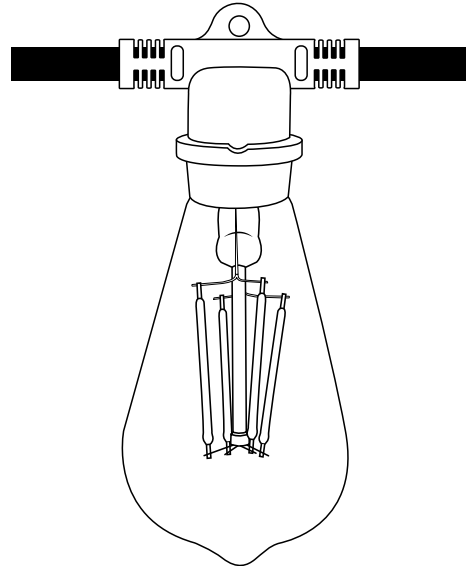

Cord Lengths Available (ft.)	Bulb Wattage	Bulb Type	Bulb Base	Dimmable	IP Rating	Operating Temperature
24 48	4	ST58	E26	Yes	IP65	-13° - 140° F

## INSTALLATION

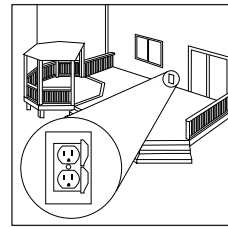

1. Identify the desired location within reach of an outlet to mount the lights.

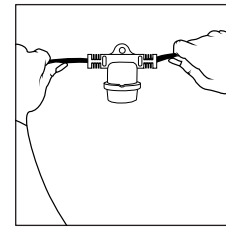

2. Hang the lights by the mounting clip on each socket.

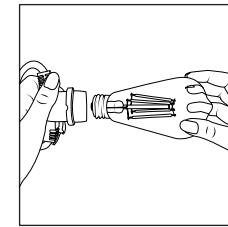

3. Screw the bulbs into the sockets along the cord.\*

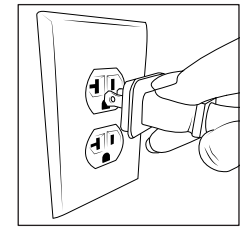

4. Plug the cord into an outlet to power the lights.

\*We recommend hanging the string before connecting the bulbs to avoid any possible damage to the bulbs during the mounting process.

## Customer Support

9 a.m. - 5 p.m. EST

(877) 298-9082

customerservice@mrbeams.com

## Mailing Address

Mr Beams U.S.  
600 Beta Drive, Unit 100  
Mayfield Village, OH 44143

www.mrbeams.com

## 1 YEAR WARRANTY AGAINST DEFECTS

All Mr Beams products are guaranteed against defects in workmanship and materials for 1 year from purchase. Warranties implied by law are subject to the same time period limitation. Some states do not allow limitations on how long an implied warranty lasts, so this time limitation may not apply to you. If the product fails due to a manufacturing defect during normal use, return the product and dated sales receipt to the store where purchased for replacement OR send the product and the dated sales receipt to Mr Beams' mailing address. Not covered – Bulbs are not covered by this warranty. Repair service, adjustment and calibration due to misuse, abuse or negligence are not covered by this warranty. Unauthorized service or modification to this product or of any furnished components will void this warranty in its entirety. This warranty does not include reimbursement for inconvenience, installation, setup time, loss of use, postage, unauthorized service, or other products used in conjunction with, but are not supplied by, Wireless Environment. This warranty gives you specific legal rights, and you may also have other rights which vary from state to state.

Register your light to extend your warranty to two years at [mrbeams.com/register](http://mrbeams.com/register)

## TIPS

Lights should be supported at sockets using suspension cable kit (not included) if no structure is available. Mount the lights with the bulbs facing down and do not cluster the bulbs. Lights should have with a minimum of 3 inches from the nearest object.

## WARNINGS

Keep away from combustible materials and do not allow the bulbs or sockets to come into contact with walls, ceilings, fabrics, etc. Not intended for installation in ceilings, enclosed spaces or aquariums. Do not overload any socket or string maximum wattage rating.

---

## IMPORTANT SAFETY INSTRUCTIONS

**When using electrical products, basic precautions should always be followed including the following:**

- READ AND FOLLOW ALL SAFETY INSTRUCTIONS.
- These products are suitable for outdoor use only. When products are used in outdoor applications, connect the product to a Ground Fault Circuit Interrupting (GFCI) outlet. If one is not provided, contact a Do not mount or place near gas or electric heaters, fireplaces, candles or other similar sources of heat.
- Do not secure the wiring of the product with staples or nails, or place on sharp hooks or nails. Install only using the mounting means provided.
- Do not let lamps rest on the supply cord or on any wire.
- Do not use this product for other than its intended use.
- Do not hang objects from cord, wire, or light string.
- Do not close doors or windows on the product or extension cords as this may damage the wire insulation.
- Do not cover the product with cloth, paper or any material not part of the product when in use.
- This product has a polarized plug (one blade is wider than the other) as a feature to reduce the risk of electric shock. This plug will fit in a polarized outlet only one way. If the plug does not fit fully in the outlet, reverse the plug. If it still does not fit, contact a qualified electrician. Do not use with an extension cord unless plug can be fully inserted. Do not alter or replace the plug. It is acceptable to omit this item if the product does not employ a polarized plug.
- This product employs overload protection (fuse). A blown fuse indicates an overload or shortcircuit situation. If the fuse blows, unplug the product from the outlet. Also unplug any additional strings or products that may be attached to the product.
- Replace the fuse as per the user servicing instructions (follow product marking for proper fuse rating) and check the product. If the replacement fuse blows, a short-circuit may be present and the product should be discarded. It is acceptable to omit this item if the fuse is not replaceable or where overload protection is not required.
- Read and follow all instructions that are on the product or provided with the product.
- SAVE THESE INSTRUCTIONS

**CAUTION: RISK OF FIRE. KEEP LAMPS AWAY FROM ANY COMBUSTIBLE SURFACE.**